

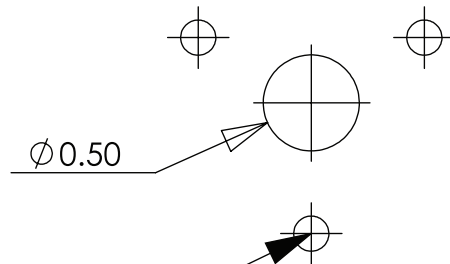

High Intensity Anywhere Light Mounting Instructions

- Drill wire exit hole in center of desired mounting position
- Place Anywhere Light in desired orientation and secure with #6 mounting screws (provided)
- Attach appropriate electrical wiring and enjoy.



#6 Self Tapping Screws (provided)

Limited Warranty

The product is warranted to be free from defects in workmanship and materials for a period of one year from the date of original purchase.

Lumitec is not responsible for product failure caused by abuse, neglect, improper installation, or failure in applications other than those for which it was designed, intended, and marketed.

Should your Lumitec product prove defective during the warranty period, promptly notify Lumitec and return product with freight prepaid. Lumitec will, at its option, repair or replace the product or defective portion without charge for parts or labor, or, at Lumitec's option, refund purchase price. Products repaired or replaced under this warranty shall be warranted for the unexpired portion of the warranty applying to the original product(s). No warranty or affirmation of fact, express or implied, other than as set forth in the limited warranty statement above is made or authorized by Lumitec, Inc. Any liability for consequential and incidental damages is expressly disclaimed. Lumitec liability in all events is limited to, and shall not exceed, the purchase price paid.

Lumitec, Inc.
1450 SW 10th Street, Suite 2
Delray Beach, FL 33444
www.lumiteclighting.com

Part # 600030



High Intensity Anywhere Light Mounting Instructions

- Drill wire exit hole in center of desired mounting position
- Place Anywhere Light in desired orientation and secure with #6 mounting screws (provided)
- Attach appropriate electrical wiring and enjoy.

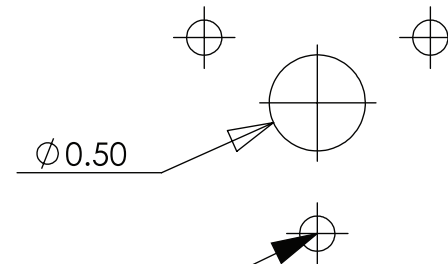

#6 Self Tapping Screws (provided)

Limited Warranty

The product is warranted to be free from defects in workmanship and materials for a period of one year from the date of original purchase.

Lumitec is not responsible for product failure caused by abuse, neglect, improper installation, or failure in applications other than those for which it was designed, intended, and marketed.

Should your Lumitec product prove defective during the warranty period, promptly notify Lumitec and return product with freight prepaid. Lumitec will, at its option, repair or replace the product or defective portion without charge for parts or labor, or, at Lumitec's option, refund purchase price. Products repaired or replaced under this warranty shall be warranted for the unexpired portion of the warranty applying to the original product(s). No warranty or affirmation of fact, express or implied, other than as set forth in the limited warranty statement above is made or authorized by Lumitec, Inc. Any liability for consequential and incidental damages is expressly disclaimed. Lumitec liability in all events is limited to, and shall not exceed, the purchase price paid.

Lumitec, Inc.
1450 SW 10th Street, Suite 2
Delray Beach, FL 33444
www.lumiteclighting.com

Part # 600030